

Visitor's Guide

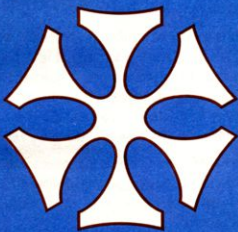

LEISURE

HOME

FASHION

FOOD

HEALTH

SECURITY

**BETTER
LIVING
CENTER**

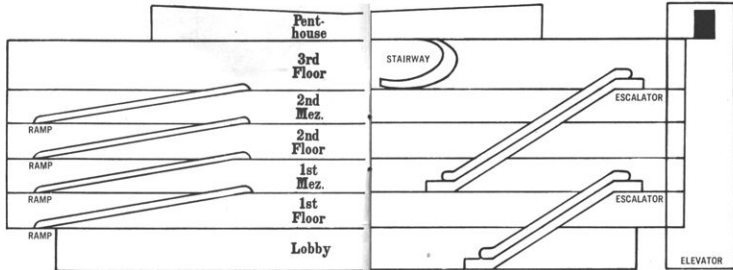

WELCOME

We are happy to welcome you, our guests, to the Better Living Center which you will truly find is a complete "Fair within the Fair."

This is the largest multiple exhibitor building at the New York World's Fair. On a two acre site, it is 80 feet high, hexagonally-shaped and encloses over a quarter million square feet of air conditioned space. It is the largest exhibit building in the Fair's industrial section, and has telescopes on the roof affording panoramic views of the entire Fair site.

The Better Living Center is the showcase for companies with products and services setting standards for a richer life in six major areas: Fashion, Food, Health, Home, Family security and Leisure.

For your greater comfort, we have provided a "top-down" traffic flow pattern. Take the glass elevators (outside, in the see-through tower) to the Penthouse observation desk and walk down the carpeted ramps through floors packed with attractions of every description... or if you prefer, escalators will take you up inside the Better Living Center. We know you'll enjoy every minute you spend in this "Fair within the Fair."

PLEASE NOTE: Better Living Center Staff is at your service for information, lost and found, first-aid. Contact any of the pages in navy blue blazers and grey slacks, or the hostesses in royal blue jumpers, or uniformed Pinkerton Guards or Building Manager's staff on second floor near elevators.

SEE BACK COVER FOR ALPHABETICAL LIST OF ATTRACTIONS



Observation deck and telescopes, international restaurant and bar, exhibitors' club.

PAGES
2-3



Food and leisure attractions, art gallery, radio station, "Elsie the Cow."

PAGES
4-5



A bazaar emporium of fascinating exhibits, gifts, demonstrations and presentations.

PAGES
8-9



Fashion and leisure attractions, tea room, enterprises of every description.

PAGES
10-11



Featuring food centers, cocktail lounge, entertainment attractions and gift offers.

PAGES
14-15



Dream Home, theater, gallery of kitchens, variety of home exhibits.

PAGES
18-19



A children's world, sidewalk cafe, toy wonderland, exhibits information center, "Spectrackular"!

PAGES
20-21

B. TELEPHONES

D. REST ROOMS

E. EMERGENCY EXITS

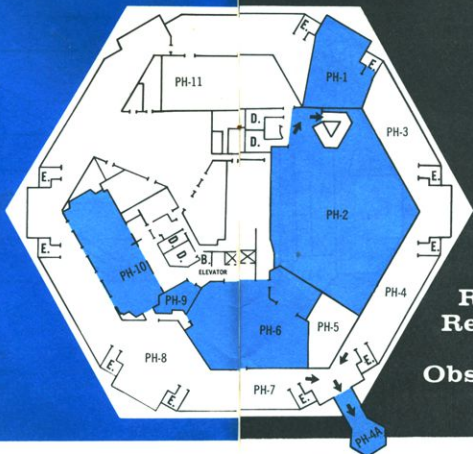

**Pent-
house**

**Roof Club
Restaurant,
and
Observation
Deck**

Major Features

GLASS ELEVATOR

Here's a thrill! Ride to the Penthouse terrace in the glass tower elevator, and watch the entire Fair unfold beneath you on the 80 foot ascent.

HILTON INTERNATIONAL CAFE

Five different kitchens feature delectable dishes from five world areas. There's a gay cocktail lounge, and dining on the terrace.

MARCO POLO CLUB

A private club for exhibitors and their guests.

WOMEN'S HOSPITALITY CENTER

Another private area, sponsored by Purex, available to members of womens clubs and organizations upon presentation of membership card.

CHARLES OF THE RITZ

The world famous beauty authority maintains a lovely Salon in the Penthouse; use interior elevator (tell guard you want the Ritz).

ROOFTOP OBSERVATION DECK

Wonderful panoramic view of entire Fair from terrace reached by outside glass elevator tower, or stairs from third floor.

- | | |
|---|---|
| PH-1 ROOFTOP OBSERVATION DECK | PH-6 MARCO POLO CLUB |
| PH-2 HILTON INT'L. CAFE
<i>Presenting Food From
Around The World</i> | PH-7 MARCO POLO CLUB
TERRACE |
| PH-3 OUTSIDE TERRACE
RESTAURANT | PH-8 PENTHOUSE TERRACE |
| PH-4 ROOFTOP OBSERVATION
DECK | PH-9 CHARLES OF THE RITZ
BEAUTY SALON |
| PH-4A GLASS ELEVATOR TOWER
RIDE | PH-10 PUREX PENTHOUSE —
<i>The Official World's Fair
Women's Hospitality Center</i> |
| PH-5 INT'L. CAFE COCKTAIL
LOUNGE | PH-11 EXECUTIVE HOSPITALITY
LOUNGE —
<i>International Telephone &
Telegraph Co.</i> |

Charles of the Ritz

Beauty Salon and Cosmetic
Boutique, Penthouse ❄ ❄
Showcase Display, Crystal
Platform of Fashion ❄ ❄ ❄

A. VISITORS HOSPITALITY LOUNGE

B. TELEPHONES

C. DRINKING FOUNTAINS

D. REST ROOMS

E. EMERGENCY EXITS

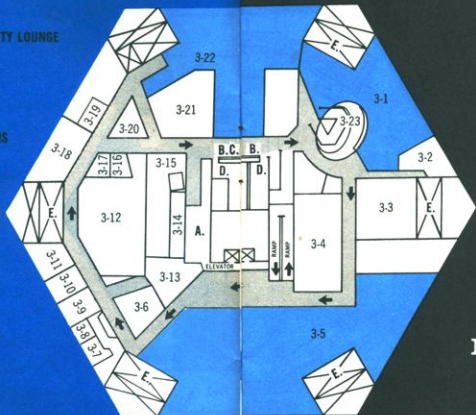

Food and Leisure Exhibits

Major Features

BORDEN'S "ELSIE THE COW"

A wonderful show, and sideshow — and you'll meet the world's most beautiful bovine!

ARNOLD PALMER PUTTING COURSE

Hey! You'll get a real kick out of this "green grass" putting course — match your wits with the traps and challenges here!

ART GALLERY

"Four Centuries of American Art" featured here, and you can get a commemorative book illustrating and describing the paintings.

BORDEN'S ELSIE CHARMS ALL

Elsie the Cow, first introduced at the New York World's Fair of 1939, is now playing to more than 30 full houses a day. "All About Elsie" is a musical revue presented every quarter hour in a theatre accommodating 1,100 persons each hour. It depicts, whimsically, a day in the life of Elsie. The bovine beauty remains stationary in center stage as toy-like sets and characters change around her.

- | | |
|--|---|
| 3-1 ART GALLERY — "4 CENTURIES OF AMERICAN MASTERPIECES" | 3-12 WHIRLPOOL CORP. |
| 3-2 GENERAL FOODS LOUNGE | 3-13 WNEW RADIO STATION |
| 3-3 SUNSHINE BISCUITS, INC. | 3-14 DENVER-CHICAGO TRUCKING |
| 3-4 CANADA DRY CORP. | 3-15 PET MILK COMPANY |
| 3-5 BORDEN'S "ELSIE THE COW" | 3-16 LEA & PERRINS, INC. |
| 3-6 MORTON SALT COMPANY | 3-17 CLAXTON BAKERY, INC. |
| 3-7 REESE CANDY | 3-18 NATURAL FOODS, INC. |
| 3-8 AMERICAN MUSHROOM INSTITUTE | 3-19 HERSHEY CHOCOLATE CORP. |
| 3-9 GROLIER SOCIETY | 3-20 CAPE CORAL |
| 3-10 CHEESE SHOPS, INC. | 3-21 HERSHEY CHOCOLATE CORP. |
| 3-11 GUY RICHARDSON AND ASSOCIATES LTD. | 3-22 LEISURE LIVING COUNTRY CLUB AND ARNOLD PALMER PUTTING COURSE |
| | 3-23 STAIRWAY TO OBSERVATION DECK AND HILTON INT'L. CAFE |

The Borden exhibit also contains a sideshow area in which animated figures entertain. A flower-bedecked fantasy ship, "Elmer's Chemical Ark," rests at anchor in the exhibit center as colorful animals march aboard to the gravel voice of Elmer singing them welcome. And for the homemaker, Borden's Demonstration Doll offers special attraction. Here costumed demonstrators present shortcuts to fabulous desserts using the latest convenience foods. Inside the Borden Theatre, Elsie presents one moo-ving performance after another.

A. VISITORS HOSPITALITY LOUNGE

B. TELEPHONES

C. DRINKING FOUNTAINS

D. REST ROOMS

E. EMERGENCY EXITS

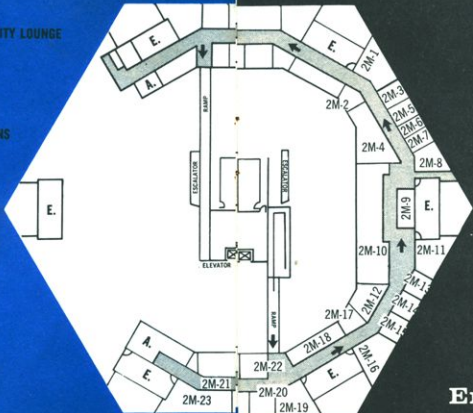

2nd
Mez.

Bazaar Emporium

BEECH-NUT THEATRE

Under the supervision of director Phil Tippin, who directed theatre at the Seattle Fair, and Jean Dalrymple, the Theatre is sponsored by Beech-Nut Life Savers, Inc. and embraces all forms of the performing arts: concerts, legitimate theatre, recitals, dance, movies—including Cinemascope—radio, television and presentations of all sorts. Located on the first floor, the 550 seat facility offers the very latest equipment from dressing rooms to two 35mm projectors with wide angle lenses.

The stage is 20 feet deep, 16 feet high, 55 feet wide and has a 35 foot proscenium opening with full theatrical lighting. Lectures, meetings and several special couture shows by fashion coordinator Eleanor Lambert are regularly scheduled.

OFFICIAL WOMEN'S HOSPITALITY CENTER

Clubwomen and other ladies' organizations have a magnificent headquarters in the Penthouse area. Called the Official Worlds Fair Women's Hospitality Center, sponsored by Purex. The magnificent lounge serves as an informal, social meeting place where women can relax in an elegant country club atmosphere. Special "Honor Days" and club meetings are frequently scheduled; but when not so occupied, your club membership card admits you to this area.

- | | | | |
|-------|-------------------------------------|-------|-------------------------------|
| 2M-1 | A. H. STOCK CO. | 2M-16 | ALFA INTERNATIONAL CORP. |
| 2M-2 | GARTNER ENTERPRISES, LTD. | 2M-17 | HOLLYWOOD HED-TOPPER MFG. CO. |
| 2M-3 | WILLIAM CHELNK ASSOC., INC. | 2M-18 | A. FEDERICO & ASSOC. |
| 2M-4 | WISCONSIN DAIRYLAND FUDGE CO. | 2M-19 | MIKADO PEARL CORP. |
| 2M-5 | F. E. COMPTON AND CO. | 2M-20 | K & N DEMONSTRATORS |
| 2M-6 | LAKE CERAMIC STUDIO | 2M-21 | MARGRO JEWELRY INC. |
| 2M-7 | FIDELIS BIBLICAL GUILD | 2M-22 | GREAT BOOKS, INC. |
| 2M-8 | VOGT APPLIANCE CO. | 2M-23 | OSTER CORP. |
| 2M-9 | GIFT-O-RAMA, INC. | 2M-24 | VENT-AIR CONTACT LENS |
| 2M-10 | NIAGARA THERAPY CORP. | 2M-25 | ROTO |
| 2M-11 | AMERICAN MASSAGE SALES & MFG. CORP. | 2M-26 | ENCYCLOPEDIA BRITANNICA |
| 2M-12 | FORTUNE ENTERPRISES | 2M-27 | MERIDIAN BRICK |
| 2M-13 | COASTAL CONSTRUCTION CO. | 2M-28 | BOMBAY SHOP |
| 2M-14 | AIDE, INC. | 2M-29 | EDEN & CO. |
| 2M-15 | TRI-CHEM., INC. | 2M-30 | KEEZER MFG. |
| | | 2M-31 | DIAL-O-MATIC |

- B. TELEPHONES
- C. DRINKING FOUNTAINS
- D. REST ROOMS
- E. EMERGENCY EXITS

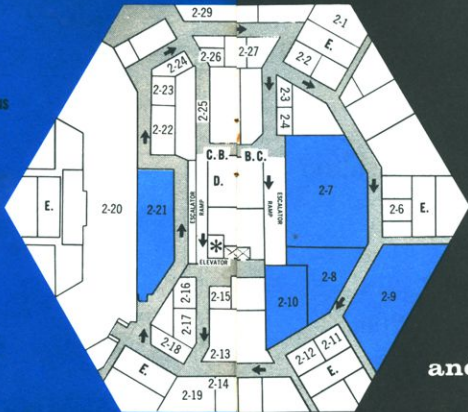

Fashion and Leisure Exhibits

Major Features

CRYSTAL PALACE OF FASHION

Major fashion facility at the Fair! At least four shows a day, produced by leading men's and women's fashion magazines.

Crystal Palace of Fashion Exhibitors

Dynel (Div. of Union Carbide Corp.)
Linde Star
Berkshire Int'l.
Lilli-Ann Corp.
Tycora Textured Yarn Co.
L'Aiglon Apparel
Don Loper, Inc.
Rosenau Bros. (Nanette Mfg. & Cinderella)
Oleg Cassini
Ritter Bros, Inc.
Sardeau, Inc.
Richelleu Corp.
Roux

American Thread Co.
Lord & Taylor
Ship 'n Shore
Charles of the Ritz
Giant Umbrella

California Fashion Creators

Altbaum	Stanley Nelson
Catalina	California Girl
Cole of Calif.	Alex Coleman
Edith Flagg	Miss Pat
Pants International	Campers Casuals
Patty Woodard	Tabac of Calif.
Koret of Calif.	Fred Rothschild
Marge Montgomery	of Calif.
Phil Rose	Ivan Frederics
Teddi of Calif.	White Stag
	Dorothy O'Hara

TETLEY TEA PLAZA

TREASURE OF THE SEA

"Live Pearl Exhibition"

WORLD COIN, STAMP, ANTIQUE EXPOSITION

AUTOMOTIVE AFTER-MARKET EXPOSITION

AMERICAN INDIAN TRADING POST

* BETTER LIVING CENTER MANAGER'S OFFICE

- | | |
|--|---|
| 2-1 THE TAYLOR PROVISIONS CO. | 2-15 PLANNED PARENTHOOD
<i>Federation of America, Inc.</i> |
| 2-2 AMERICANA | 2-16 LEO J. OVERTOOM |
| 2-3 MASON CANDIES, INC.
<i>Industry for Youth</i> | 2-27 LAY-CEE CORP. |
| 2-4 MONOGRAM MODELS, INC.
<i>Industry for Youth</i> | 2-18 P. F. COLLIER, INC. |
| 2-5 ACOUSTIC RESEARCH, INC. | 2-19 WORLD JEWELRY CORP. |
| 2-6 NATIONAL DOCUMENTS
COMMITTEE | 2-20 CRYSTAL PALACE OF FASHION |
| 2-7 AMERICAN INDIAN TRADE
FAIR | 2-21 TETLEY TEA PLAZA |
| 2-8 TREASURE OF THE SEA | 2-22 THE LOVABLE CO.
2-23 SUZY BROOKS |
| 2-9 WORLD COIN, STAMP,
ANTIQUE EXPOSITION | 2-24 FORTUNE ENTERPRISES |
| 2-10 AUTOMOTIVE AFTER-MARKET
EXPOSITION, INC. | 2-25 FRONTIER VILLAGE
<i>"Tumbleweed Junction"</i> |
| 2-11 R. A. FISCHER & CO. | 2-26 DIMAGGIO |
| 2-12 GROLIER SOCIETY | 2-27 RELAX-4-LIFE |
| 2-13 NORTH AMERICAN PHILIPS
CO., INC. | 2-28 AMERICAN PHOTOGRAPHIC
CORP. — |
| 2-14 FLAGSTADT RECORDS | 2-29 NATIONAL INDUSTRY FOR
THE BLIND |

FRONTIER VILLAGE

"Tumbleweed Junction" they call it, and, pardner, when you enter the Frontier Village, you leave modern civilization behind!

Right above your head

Armin Jung
of the Panama Hilton
and his platoon
of chefs
are cooking food
Mom never even
dreamed about.

Hungry?

Come right up to the Hilton Cafe International atop the Better Living Center. It has 5 kitchens, 5 cuisines. Chefs from North America and from South America, the Mediterranean, the Orient and Europe (flown here by BOAC). You can choose your meal from any or all of them. The cost? Surprisingly low. (Don't want to bother going all the way up? You can stop off at any of the other fine eating places at the Better Living Center. They all serve the same delicious Hilton food and drinks.)

Visit the *Carte Blanche* and
Hilton Reservation Service exhibit.



Carte Blanche®

Fly BOAC... and go international with all the comforts of Hilton.

There are Hilton hotels all over the world. In Acapulco, Amsterdam, Athens, Atlanta, Berlin, Boston, Buffalo, Cairo, Chicago, Cincinnati, Cleveland, Dallas, Dayton, Denver, Detroit, Dorado, El Paso, Guadalajara, Hartford, Honolulu, Hong Kong, Houston, Istanbul, Jamaica, Kansas City, Mo., London, Los Angeles, Madrid, Mayaguez, Mexico City, Milwaukee, Montreal, New Orleans, New York (*Waldorf-Astoria, Statler Hilton, New York Hilton*), Panama, Pittsburgh, Portland, Ore., Rome, Rotterdam, San Francisco, San Juan, St. Louis, St. Thomas, Santiago, Seattle, Sydney, Tarrytown, Tehran, Tokyo, Trinidad, Vancouver, Washington, D.C.

You can make immediate reservations for any of these hotels at the Cafe International. Or call LOnacre 3-6900. Charges at all Hilton hotels can be paid for on your *Carte Blanche* Credit Card or Hilton Credit Identification Card.

Hilton Hotels
CORPORATION
CONRAD N. HILTON, PRESIDENT

1st
Mez.

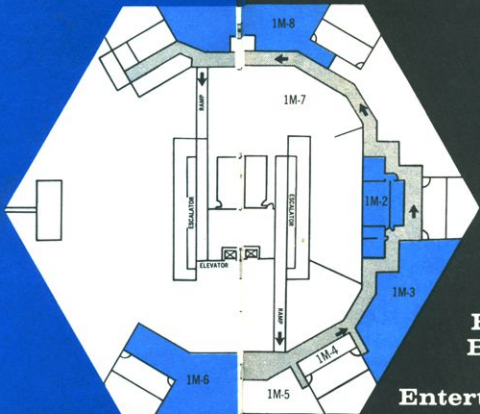

Food and Beverage Center Entertainment

Major Features

INSTANT FOOD SERVICE

Every visitor will appreciate this! Here's "instant" food, in good variety—tasty as can be—and none more reasonable at the Fair.

COCKTAIL LOUNGE

Relax... Here's a quiet corner, and an excellent bar. Everything your palette calls for, served graciously at reasonable prices.

WTFM BROADCASTING

View broadcasts of three programs about the Fair six times a day from the studio here. WTFM has the only full time FM-stereo multiplex facility in New York metropolitan area, and also feeds Boston, Philadelphia and Washington.

SOUVENIRS

Sure, there are souvenirs all around the Fair—but wait till you see the variety of unique and special ones here!

1M-1 TAYLOR PROVISION CO.

1M-2 WTFM

1M-3 ENTERTAINMENT

1M-4 GIFT-O-RAMA

1M-5 ENTERTAINMENT

1M-6 COCKTAIL LOUNGE

1M-7 MAXWELL HOUSE COFFEE

1M-8 AUTOMATIC FOOD AND
BEVERAGE SERVICE

INTERNATIONAL DINING IN THE PENTHOUSE

The colorful Hilton Cafe International occupies a spacious area in the Penthouse. Five open kitchens offer authentic foods of five different world locales: North America, South America, Europe, the Mediterranean and the Orient. Patrons may walk directly from one to another to select a variety of dishes or snacks. They may also limit their selections to only one kitchen, as each can provide a complete meal. The kitchens are supervised by famous cooks from Hilton Hotels around the world.

There is an adjacent Cocktail Lounge which comfortably seats 55 guests. The decor reflects the festival spirit of a world's fair, with designs of multi-colored pennants, a striped awning over the bar, painted metal furniture with vari-colored cushions and table tops.

CHILDREN'S CENTER TEACHES TOTS

The children's center is completely surrounded with one-way glass enabling parents and visitors to see the tots without disturbing their play or studies. In the play area there are experimental toys and climbing gear, a tele-trainer for good telephone manners, blocks and a baby lamb to be fed. Here the children also churn butter and make ice cream for their own consumption. In the science area, the tots watch the hatching of live chicks, observe the goings on in their own cutaway beehive and ant colony, learn about magnetism and dramatize science materials. And in the art area, they paint and sculpt, learning the use of a globe—and have a snack of juice or ice cream and crackers.



Welcome to the good life. At Dorothy Draper's Dream Home all the towels are Martex

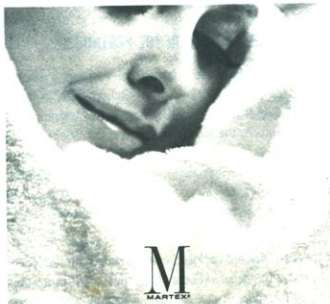

M
MARTEX



MARTEX TOWELS... A PRODUCT OF THE WEST POINT MANUFACTURING COMPANY
Masters, 111 West 40th Street, New York City

4-minute break at Morton Salt!

Stop walking . . . pause while you see and hear the story of the food so common you can forget it's around; yet so vital you can't live without it. Enjoy "Salt of the Earth." In 4 minutes, experience a million years of salt history as you gaze into Morton's giant salt crystal millions of times normal size. Be our guest and rest.

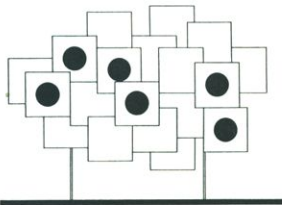

DAILY FASHION SHOWS IN CRYSTAL PALACE

The Crystal Palace of Fashion (second floor) features a new fashion show schedule of the coming season's clothes, concluding with a finale of spectacular evening clothes by top designers.

The Crystal Palace has become the major fashion facility at the Fair, and also incorporates a tea plaza. The daily Better Living Center show, coordinated by Eleanor Lambert, offers the cream of all-American fashion from active sportswear through evening clothes—plus furs, accessories, jewelry and cosmetics.

FOUR CENTURIES OF AMERICAN ART

The Better Living Center has appointed the famed Skowhegan School of Painting and Sculpture to supervise a major art effort unprecedented in either galleries or museums. You may see it in the third-floor Art Gallery—it's called "Four Centuries of American Masterpieces."



A. VISITORS HOSPITALITY LOUNGE

B. TELEPHONES

C. DRINKING FOUNTAINS

D. REST ROOMS

E. EMERGENCY EXITS

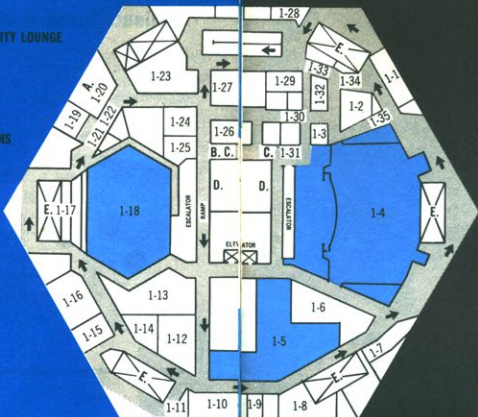

Home Exhibits

Major Features

DOROTHY DRAPER'S WESTINGHOUSE DREAM HOME

... a uniquely styled seven-room fan-shaped "dream home" with emphasis on color, coordinated design and spacious luxury.

Dream Home Exhibitors

B. Altman - Salterini
 Amtico Flooring Division, Inc.
 American Bitlrite Rubber Co.
 Anchor Hocking Glass Corp.
 California Artificial Flower Co.
 Charles Bloom, Inc.
 Carthage Marble Corp.
 Eljer Plumbingware
 Erkins Studios, Inc.
 Kim Flocking Co.
 Gadjjo Corporation
 Grolier Society
 Henredon Furniture Co.
 Johns-Manville
 W. W. Kimball Co.
 Samuel Kirk & Son, Inc.

BEECH-NUT THEATRE

All forms of the Performing Arts—Daily Schedule of Events

A GALLERY OF KITCHENS

Full-scale rooms feature the most advanced electric and gas appliances, floor coverings, metal and wood cabinets and counters, plumbing fixtures and portable appliances.

Gallery of Kitchens Exhibitors

Caloric Corp.
 Jenn-Air Corp.
 Kemper Bros.
 Schlumberger Ltd.
 Waste King Corp.
 I-XL Furniture Co.
 Hobart Mfg. Co.
 Thomas Strahan Co.
 Birge Co., Inc.
 Nevamar Co.
 Landers, Frary & Clark
 Tupperware
 Hupp Corp.
 Pioneer Plastics Corp.
 Marsh Wall Products
 Ronkonkoma Wallpaper Co.
 Admiral Corp.

- 1-1 U.S. PLYWOOD CORPORATION
 1-2 F. SCHUMACHER & CO.
 1-3 DUNBAR FURNITURE CO.
 1-4 BEECH-NUT THEATER
 1-5 GALLERY OF KITCHENS
 1-6 HOUSEWARES AND APPLIANCES
 1-7 OXFORD FURNITURE DISTRIBUTING CO.
 1-8 MARSH WALL PRODUCTS
 1-9 MANPOWER, INC.
 1-10 WHIRLPOOL CORP.
 1-11 U.S. AUTOMATION, INC.
 1-12 JOHNS-MANVILLE SALES CORP.
 1-13 RONSON CORP.
 1-14 ELJER PLUMBINGWARE
 1-15 GADJO CORP.
 1-16 CALIFORNIA ARTIFICIAL FLOWER CO.
 1-17 PITTSBURGH CORNING CORP.
 1-18 DOROTHY DRAPER'S WESTINGHOUSE DREAM HOME
 1-19 MORGAN-JONES, INC.
 1-20 VISITORS HOSPITALITY LOUNGE
 1-21 CULLIGAN
 1-22 MARY CARTER PAINT CO
 1-23 TELEVISION COMMUNICATION CENTER
 1-24 CONTOUR CHAIR, LOUNGE CORP.
 1-25 SCHICK, INC.
 1-26 FIELDCREST MILLS, INC.
 1-27 SUNBEAM CORP.
 1-28 AMERICAN REALTY PETROLEUM CORP.
 1-29 YALE & TOWNE
 1-30 PHILLIP LAVEREN
 1-31 BISSELL MFG. CO.
 1-32 BOOK OF THE MONTH CLUB, INC.
 1-33 INSTITUTE OF HIGH FIDELITY
 1-34 CRAFTS GUILD (CANDLE BARN)
 1-35 J. PIERCE STEVENS

B. TELEPHONES

C. DRINKING FOUNTAINS

D. REST ROOMS

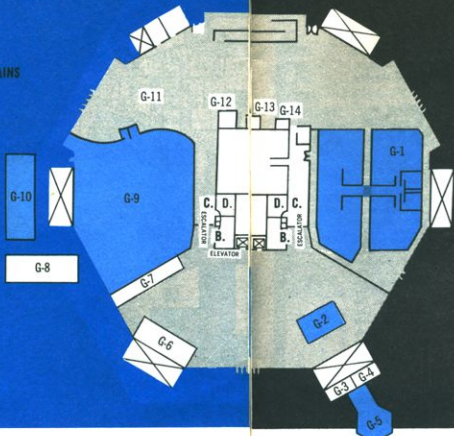

Lobby

Major Features

THE CHILDREN'S WORLD

Park your tots here for two hours—they'll love it (and you will too). Run by personnel who operated this popular feature in Seattle, the Center concentrates on areas of play, science and art.

WORLD'S LARGEST MODEL TRAIN

"Spectrackular"! See the world's largest and most complex scale-model railroad...including complete cities, thousands of buildings, people and cars, ships...a circus—and rockets blasting off!

CAVALCADE OF COMICS

An historic exhibit of comics ranging from the turn of the century.

SIDEWALK CAFE

Refresh yourself "out in the open" in this Hilton-operated Sidewalk Cafe—none better on the Rue de la Paix; charming service.

GLASS ELEVATOR

Here's a thrill! Ride to the Penthouse terrace in the glass tower elevator, and watch the entire Fair unfold beneath you on the 80 foot ascent.

G-1 CHILDREN'S WORLD

G-2 CALVADE OF COMICS
Newspaper Comics Council

G-3 B & M BEANS

G-4 TETLEY TEA STAND

G-5 GLASS ELEVATOR TOWER
RIDE

G-6 DATA INFORMATION CENTER
Data Patterns, Inc.

G-7 HISTORIC RAILROAD MUSEUM

G-8 THE "GENERAL" LOCOMOTIVE
Actual Famous Civil War Engine

G-9 WORLD'S LARGEST MODEL
RAILROAD SPECTRACKULAR

G-10 SIDEWALK CAFE

G-11 TOY WONDERLAND

G-12 TETLEY TEA STAND

G-13 B & M BEANS

G-14 HERSHEY CHOCOLATE CORP.

WORLD'S LARGEST SCALE-MODEL RAILROAD DISPLAY

"The World's Greatest Spectrackular," largest and most complicated scale-model railroad display ever constructed, is on the main floor of the Better Living Center. It was built and is run by Bertram Otto, president of the Thames Ditton Model Railway Society of Thames Ditton, Surrey, England.

This unique attraction houses over 2¾ miles of track, with some 1,000 pieces of rolling stock, including 400 locomotives of every description and of some eight different nationalities!

Sun-drenched petal tints from Bloomcraft in fashion-bright fabrics designed by Dorothy Draper for her Dream Home. Lavish them on your home! Pick a bunch at all the fine stores listed below.



ALABAMA, Birmingham, Albert Bluttman Interiors CALIFORNIA, Los Angeles, Bullock's, Inc., Sherman Oaks, Bullock's San Fernando, HOLLYWOOD, Denver, The Denver Dry Goods Co. CONNECTICUT, Hartford, G. Fox & Co. FLORIDA, Jacksonville, May-Cobens, Orlando, Ivey's of Orlando, Inc. GEORGIA, Atlanta, Rich's, Inc. ILLINOIS, Chicago, Goldblatt Bros., Inc. INDIANA, Ft. Wayne, Quality Furniture Shop, Indianapolis, L. S. Ayres & Co., Inc. IOWA, Des Moines, Younker Bros., Inc. KENTUCKY, Louisville, Stewart Dry Goods Co. LOUISIANA, Monroe, The Palace Inc., New Orleans, Krauss Co., Ltd. MARYLAND, Baltimore, Hutzel Brothers MASSACHUSETTS, Boston, Jordan, Marsh Co. MICHIGAN, Detroit, Decorative Interiors Inc., Grand Rapids, Warzburg Co. MINNESOTA, Minneapolis, Dayton Co. MISSOURI, Kansas City, Duff & Repp, Inc., St. Louis, Stix, Baer & Fuller Co. NEBRASKA, Omaha, J. L. Brandeis & Sons NEW JERSEY, Newark, Bamberger's New Jersey, Plainfield, Tepper's Plainfield Inc. NEW YORK, Albany, The Mayfair, Inc., Corning, Hamel's Decorative Furnishings, Elmira, J. P. & M. Sullivan, Ithaca, Wissen Fabrics Co., Inc., New York City, Macy's New York, Newburgh, Frank Niering & Co., Inc., Utica, Boston Store OHIO, Athens, Baker & Stauffer, Cincinnati, Burton Fabrics, Cleveland, The Halle Bros. Co., Dayton, Rike-Kumler Co., Lorain, Oberlin Ave. Carpet Shop PENNSYLVANIA, Philadelphia, Strawbridge & Clothier, Pittsburgh, Joseph Horne Co. TENNESSEE, Chattanooga, Fowler Bros. Co., Kingsport, Casto's, Knoxville, Miller's Inc., Memphis, J. Goldsmith & Sons TEXAS, Abilene, Thornton's Dept. Store, Galveston, Plantowsky's Inc., Houston, Foley Bros. D. G. Co., Lubbock, Dunlap's UTAH, Salt Lake City, H. Dinwoody Furniture Co. VIRGINIA, Norfolk, Cofer Associates, Inc., Richmond, Thalheimer Bros. WEST VIRGINIA, Charleston, The Diamond WISCONSIN, Milwaukee, Boston Store WASHINGTON, D.C., Woodward & Lothrop

All of the fabrics designed for Bloomcraft by Dorothy Draper are made of **CELANESE®** fibers and **AVRII®** rayon and cotton.

**BLOOMCRAFT
DECORATIVE
FABRICS**

Charles Bloom, Inc., 15 E. 26th St., New York 10

See them for yourself:
INTAGLIO Glass Wall Units... a completely new wall or partition material from Pittsburgh Corning. Installed in the Dorothy Draper Dream House as a patio wall, and in the main entrance as interglaze partitions. Also serves as an exterior wall along the exit ramp to the ground floor.

Only all-glass INTAGLIO units can combine a lovely grill or screen appearance, complete with full insulation, sound reduction and freedom from maintenance. For information, check the Dream House information booth, or mail this coupon to Pittsburgh Corning.

Pittsburgh Corning Corporation Dept. WP-54, One Gateway Center
 Pittsburgh, Pa. 15222

I am interested in INTAGLIO Glass Wall Units for application in:

Would like literature _____ Information on where to buy _____

Name _____
 Occupation _____
 Address _____

PITTSBURGH
PC
 CORNING

Index To Attractions

Acoustic Research, Inc.	PAGE 11	K & N Demonstrators	PAGE 9
Aide, Inc.	9	Lake Ceramic Studio	9
Alfa International Corp.	9	Lay-Cee Corp.	11
Americana	11	Lea & Perrins, Inc.	5
American Indian Trade Fair	11	Leisure Living Country Club and Arnold Palmer Putting Course ...	5
American Massage Sales & Mfg. Corp.	9	The Lovable Co.	11
American Mushroom Institute ..	5	Manpower, Inc.	19
American Photographic Corp. ...	11	Marco Polo Club	3
American Realty Petroleum Corp..	19	Marco Polo Club Terrace	3
Art Gallery	5	Margro Jewelry Inc.	9
Automotive After-Market Exposition, Inc.	11	Marsh Wall Products	19
Automatic Food and Beverage Service	15	Mary Carter Paint Co.	19
Beech-Nut Theater	19	Mason Candies, Inc.	11
Bissell Mfg. Co.	19	Maxwell House Coffee	15
B & M Beans	21	Mikado Pearl Corp.	9
Book of the Month Club, Inc. ...	19	Monogram Models, Inc.	11
Borden's "Elsie the Cow"	5	Morgan-Jones, Inc.	19
Cape Coral	5	Morton Salt Company	5
California Artificial Flower Co. ...	19	National Documents Committee..	11
Cavalcade of Comics	21	National Industry for the Blind..	11
Canada Dry Corp.	5	Natural Foods, Inc.	5
Charles of the Ritz Beauty Salon. 3		Niagara Therapy Corp.	9
Cheese Shops, Inc.	5	North American Phillips Co., Inc..	11
Children's World	21	Oster Corp.	9
Claxton Bakery, Inc.	5	Outside Terrace Restaurant	3
Coastal Construction Co.	9	Leo J. Overtoom	11
Cocktail Lounge	5	Oxford Furniture Distributing Co..	19
P. F. Collier, Inc.	11	Penthouse Terrace	3
F. E. Compton and Co.	9	Pet Milk Company	5
Contour Chair, Lounge Corp. ...	19	Phillip Lavern	19
Crystal Palace of Fashion	11	Pittsburgh Corning Corp.	19
Culligan	19	Planned Parenthood	11
Data Information Center	21	The Official World's Fair Women's Hospitality Center	3
Denver-Chicago Trucking	5	Reese Candy	5
DiMaggio	21	Relax-4-Life	11
Dorothy Draper's Westinghouse Dream Home	19	Ronson Corp.	19
Dunbar Furniture Co.	9	Rooftop Observation Deck	3
Eijer Plumbingware	19	Schick, Inc.	19
Entertainment	15	F. Schumacher & Co.	19
Executive Hospitality Lounge ...	3	Sidewalk Cafe	21
A. Federico & Assoc.	9	Spectrakular	21
Fidelis Biblical Guild	9	Stairway to Observation Deck and Hilton Int'l. Cafe	5
Fieldcrest Mills, Inc.	11	J. Pierce Stevens	19
R. A. Fischer & Co.	11	A. H. Stock Co.	9
Flagstadt Records	11	Sunbeam Corp.	19
Fortune Enterprises	9-11	Sunshine Biscuits, Inc.	5
Frontier Village	11	Suzy Brooks	11
Gadjo Corp.	19	Taylor Provision Co.	11-15
Gallery of Kitchens	19	Television Communication Center.	19
Gartner Enterprises, Ltd.	9	Tetley Tea Plaza	11
General Foods Lounge	5	Toy Wonderland	21
The "General" Locomotive	21	Treasure of the Sea	11
Gift-O-Rama, Inc.	9-15	Tri-Chem., Inc.	9
Glass Elevator Tower Ride ...	3-21	U.S. Automation, Inc.	19
Great Books, Inc.	7	U.S. Plywood Corporation	19
Grolier Society	5-11	Visitors Hospitality Lounge	19
Guy Richardson and Associates, Ltd. 5		Vogt Appliance Co.	9
Hershey Chocolate Corp.	5-21	Whirlpool Corp.	19-5
Hilton Int'l. Cafe	3	William Chelnik Assoc., Inc. ...	9
Historic Railroad Museum	21	Wisconsin Dairyland Fudge Co... 9	
Hollywood Hed-Topper Mfg. Co... 9		WNEW Radio Station	5
Housewares and Appliances	19	World Coin, Stamp, Antique Expos.	11
Institute of High Fidelity	19	World Jewelry Corp.	11
Int'l. Cafe Cocktail Lounge	3	WTFM	15
Johns-Manville Sales Corp.	19	Yale & Towne	19